

# C6/105/2 COLUMN PROFILE

Profile Length  
includes Covers  
and Floor Mount  
Brackets  
3.1m - 105.2236  
6.2m - 105.2266

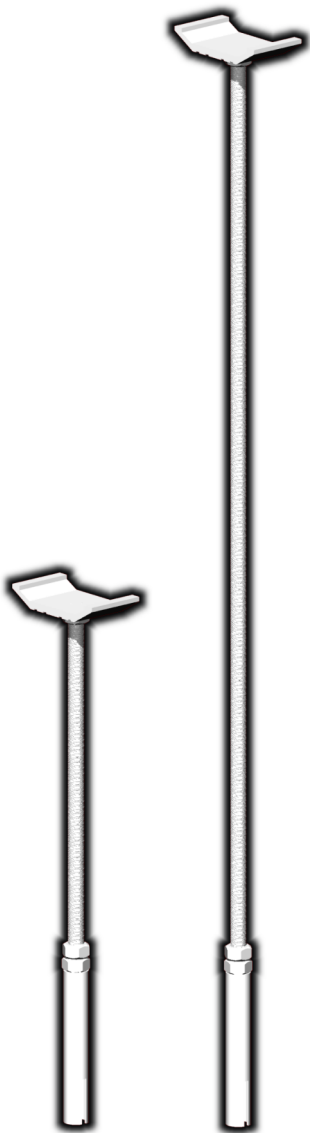
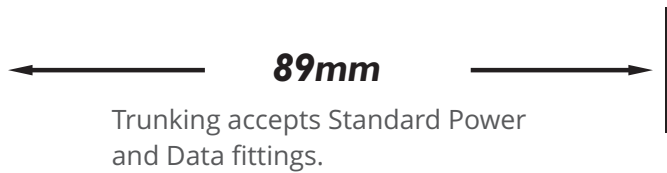
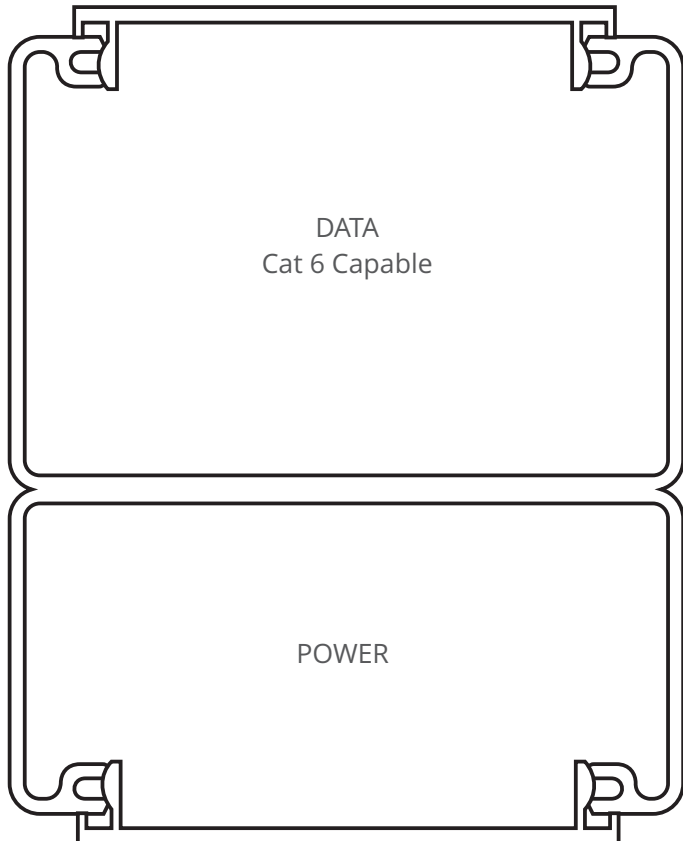

45 Degree End Caps  
Left Ending - 180.2606  
Right Ending - 180.2616

Compression Jacks  
300mm - 15.3000  
600mm - 15.6000



PVC Ceiling Flange  
105.2256



Power and Data  
Fixing Plates  
70.0040  
(Pairs)

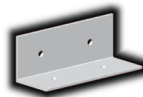

Floor Mounting  
Brackets  
105.2456  
Supplied fixed to  
rectangular  
column profiles